

BORDEAUX

60 x 20

Park and manufacturer are working in unison at The Vines, a new area at Mount Pleasant Park, York, that Steve Gray visited on page 34. Anne Webb finds out more about the first home from Omar to be sited there

The Vines aims to promote the utmost in luxury and this theme will extend to the homes sited there. They will not all be the same, however, as the Holgate family is aware that tastes in furnishing, decor and layout will vary.

The first home to be sited was exhibited by Omar at this year's Park Home Lifestyle Show at Stoneleigh, and its size – 60 x 20ft – and upmarket yet traditional decor, were major talking points. Add to this some £10,000-worth of audio visual entertainment equipment and you have a home that is breaking new ground.

It's called the Bordeaux largely because of its sumptuous deep red lounge colour scheme. Visitors who saw this particular home at the show would have seen firsthand the type of landscaping that will surround it. The intention is for home and landscape to work together to reduce the impact on the environment. This Omar home has four sets of French doors creating opportunities for the home and its surrounding garden to work together.

The Bordeaux has a front sun lounge with two sets of French doors. However, the main entrance to this home is a single door under a gable roof at the side. This door is slightly recessed and there is a glass panel adjacent

letting in more light. As you enter you are immediately struck by the luxurious touches – white carpet, cherry wood furniture and silk inter-lined drapes. There is a wide three-drawer chest at the back of the hall, with a mirror on the wall above – ideal for checking your appearance before going out, and for picking up gloves, scarves, handbags etc stored in the drawers.

A door gives access to the dining area and here, and throughout the rest of the home, the French chateau styling is much in evidence.

1 DINING AREA

The circular dining table can be extended to an oval shape for entertaining and the four chairs plus two carvers have padded seats and curved backrests upholstered in a cream faux suede. A chandelier-style light hangs from the ceiling with individual black silk shades.

The window in the dining area is fairly deep and in common with those throughout the home is double-glazed, uPVC-framed and fitted with Georgian glazing bars. Blackcherry silk curtains are full, pinch pleated and hang to floor level from decorative wooden poles, while a semi-circular sideboard in a very grand design provides plenty of storage space in



DINING AREA Circular table can be extended

cupboards which flank a central drawer unit.

An archway on the front wall of the dining area gives access to the lounge which stretches across the whole width of the home, behind the sun lounge which is also full width.

2 LOUNGE

Sumptuous is the only word to adequately describe the lounge. The two-seater sofas are large and comfortable, featuring plush upholstery with a white background and deep red pattern. Some cushions are covered in a striped pattern and

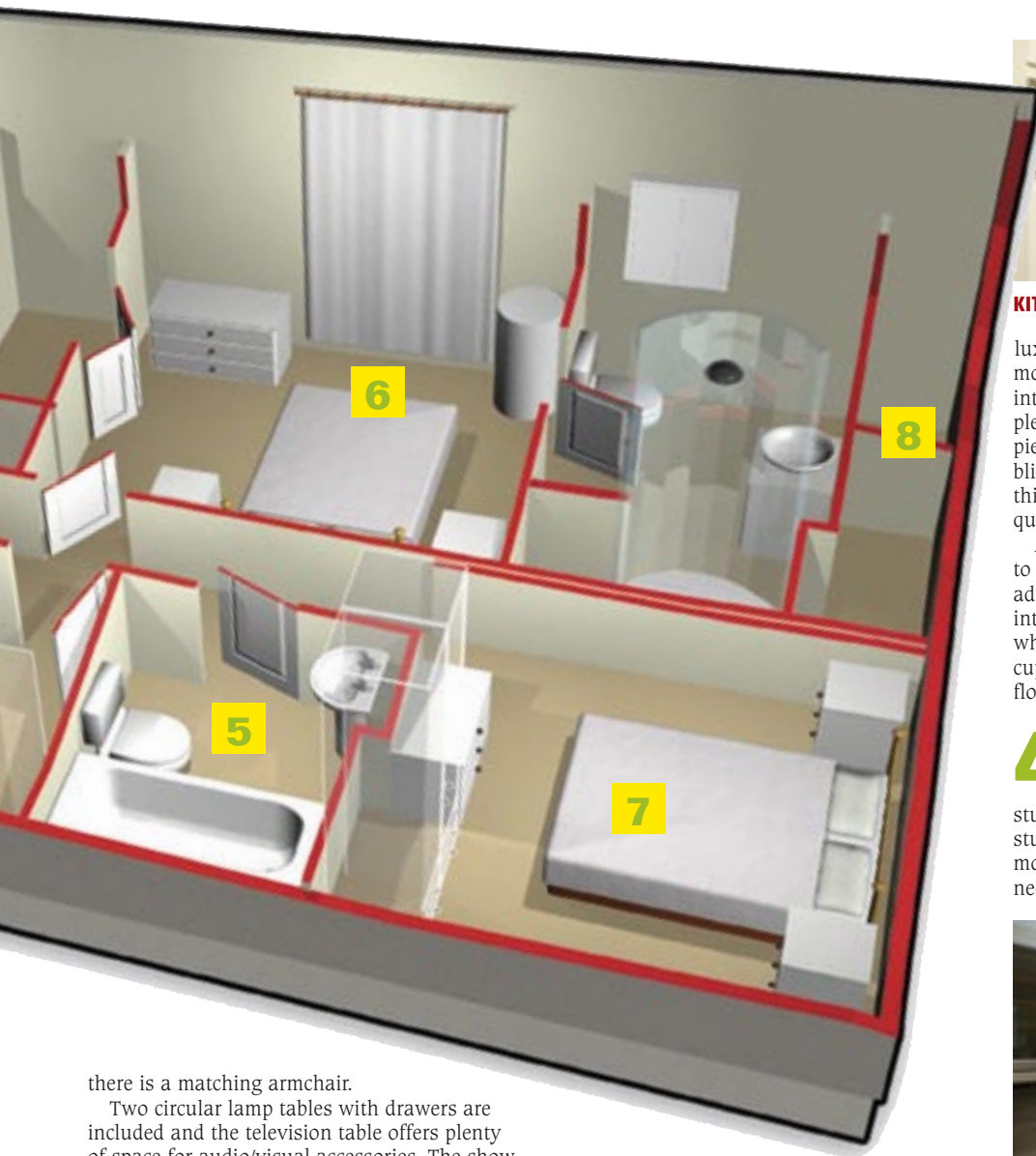

there is a matching armchair.

Two circular lamp tables with drawers are included and the television table offers plenty of space for audio/visual accessories. The show model featured here included some £10,000-worth of this equipment with a very impressive control console. That is obviously an optional extra but was included in the show home to demonstrate the type of features that can be included in a luxury home like this. There was also an electronic lighting control system, ensuring you get the right mood both indoors and out.



LOUNGE Sumptuous styling and large sofas

There is a deep window on one side of the lounge and on the opposite there are French doors, which, when sited, will give access to a patio or garden area.

By comparison with the rest of the lounge decor, the log-effect electric fire is quite modern but blends in well, while wall lights

matching the central lights are fitted on the fireplace wall.

A double door on the dining side of the lounge gives access to the sun lounge area which has a vaulted ceiling and two French doors on the front wall, with curved windows around the front corners and more windows at the side. Furniture for this area will be provided to the customer's choice. Some people may choose to furnish it as a garden room, possibly with cane furniture, while others may choose to make it a lounge extension in more traditional styling.

3 KITCHEN

Access to the kitchen is from the dining area, and there is an exterior door in the utility area. The Holgates believe that working areas like the kitchen should be as efficient and labour-saving as possible. Worktops are solid wood with white painted units and stainless steel appliances are from the Smeg range with the exception of the large American style Maytag fridge freezer with its drinks cooler and ice-maker.

As you enter from the dining area there are floor to ceiling cupboards incorporating a microwave oven. There's a large range cooker with a chimney hood and to add to the



KITCHEN Features luxury underfloor heating

luxurious feel, a flat-screen television is wall-mounted in the corner. The kitchen has an integrated dishwasher and as expected there's plenty of storage space for all your bits and pieces. The window is fitted with Venetian blinds. Ceiling-mounted spotlights illuminate this area, while the floor covering is high quality wood effect vinyl.

An archway at the back of the kitchen leads to the matching utility area where there's an additional sink. Underneath the worktop is an integrated washing machine and tumble dryer, while a door on the right gives access to the cupboard housing the manifold for the under-floor heating system and boiler.

4 STUDY

On the opposite side of the home, the area 'behind' the hallway houses the study, bathroom and second bedroom. The study is small and compact and, of course, modern as it has been fitted out to meet the needs of someone who is likely to use it as a



STUDY A great place to surf the internet

computer room. It is a flexible area and could also double as a hobbies room. If you like a tippie, the show model also demonstrated another use – a wine storage area.

A wood-look Venetian blind is fitted at the window and the area is illuminated by spotlights. In the hallway just outside the study a hatch gives access to extra storage space in the loft.

5 BATHROOM

The bathroom, is accessed from the hallway and features a white Sottini suite. A white Venetian blind is fitted at the obscure glass window and the basin has a



BATHROOM Simple, yet modern and stylish



mirror on the wall above, flanked by wall lights. There's also a ladder-style heated towel rail. Tongue and groove paneling is painted in a light eggshell finish blending perfectly with the light wood effect vinyl flooring.

6 MASTER BEDROOM

The master bedroom suite is on the opposite side of the home. The carpet and furniture are white but styling is traditional with attractive curves on the furniture. For example, the bedside tables have curved fronts and there is a circular storage cabinet and a wide three-drawer chest.

A particularly nice feature in this room is

access to your outside space through French doors. How decadent it would be to have breakfast on the patio outside your bedroom!

Curtains hang full length at the French doors and are cream linen printed with a duck egg blue pattern and tie backs. Both this room and the second bedroom are lit by beautiful glass chandeliers.



MASTER BEDROOM Lit by a beautiful chandelier

There's a walk-in wardrobe with plenty of hanging rails and shelves and an en suite shower room featuring a long shower tray with a Matki combination shower. The basin is a modern countertop style and sits on travertine marble vanity unit, while the close coupled low flush toilet sits adjacent to an obscure glass window with Venetian blind. Decor follows in the style of the main bathroom.

7 SECOND BEDROOM

The second bedroom is in similar style to the master and features a double door free-standing wardrobe with drawer storage in the base and a six-drawer chest adjacent.

The bed and bedside tables are the same as those in the master, as are the printed silk curtains at the deep window.

8 EXTERIOR STORAGE

There are two areas behind the master bedroom that are storage areas accessed

GET THE LOOK

The Bordeaux is a special design for a special park, demonstrating just how luxurious a park home can be. It's the flagship for the Vines and no expense has been spared. Fixtures, fittings and appliances are top quality.

Omar does point out, however, that it can tailor homes to customer requests and would be happy to design a bespoke home with luxurious features. Remember though – these will come at a price.

The Holgate family is full of enthusiasm for the Bordeaux's excellent interior by designer, Gaynor Evans, but appreciate that the French chateau style might not be to everyone's taste, and are currently offering other choices of high quality homes from fellow park and leisure home manufacturer, Wessex.

from the outside of the home. The owners of The Vines are keen to preserve the immaculate appearance of the park and this might not have been possible if individual sheds and storage units had been allowed.

However, they recognized that storage space is always needed so provided some in the loft and more here. One is approximately 5ft 6in wide by 2ft 6in deep and 8ft high with double door access and power points and the other is around 3ft 6in wide with single door access. ■

Information

The 60 x 20ft Bordeaux model reviewed here was photographed at the Park Home Lifestyle Show in Stoneleigh. It was commissioned by Holgates for its new development at The Vines, York, and is currently available there. Fully sited prices will depend on the level of specification chosen but are expected to be up to £300,000. ☎ 0845 456 1758.

Omar Bordeaux 60 x 20 At a glance

SIZE: 60 x 20ft (including 8ft sun lounge)

BEDROOMS: Two doubles, master with walk-in wardrobe and en suite shower room

BATHROOMS: One bathroom and one en suite shower room

WINDOWS AND DOORS: uPVC framed and double glazed with Georgian bar finish. French doors to sun lounge, lounge, master bedroom.

Single entrance door to hall and exterior door to utility. Two solid doors on back wall giving access to exterior storage cupboards

PRICE: Around £300,000 fully sited and landscaped at The Vines, Yorkshire

MANUFACTURER: Omar Homes Ltd, London Road, Brandon, Suffolk IP27 ONE.

Telephone 01842 810673

Fax 01842 814328

www.omar.o.uk